



## February 2020 New Features Bulletin

Here is a summary of the new features and improvements released during February 2020. [Links to all previous bulletins can be found here.](#)

### DASHBOARDS!!

If you've not yet discovered the new custom dashboards feature, **please watch this video:** [watch on YouTube](#)

As described by one coach: *"I absolutely LOVE the dashboards feature, especially the "show when I log in". That is going to totally change the game. Easily my favorite new feature of iCrew."*

**NOTE:** A couple of things about dashboards not shown in the video:

- 1) If you add a tile for a page related to a session, like the check-in or line-ups page, iCrew will always open the page for the current day's session or the next session on the calendar.
- 2) You can add a tile to an existing dashboard that links to a page outside of iCrew.

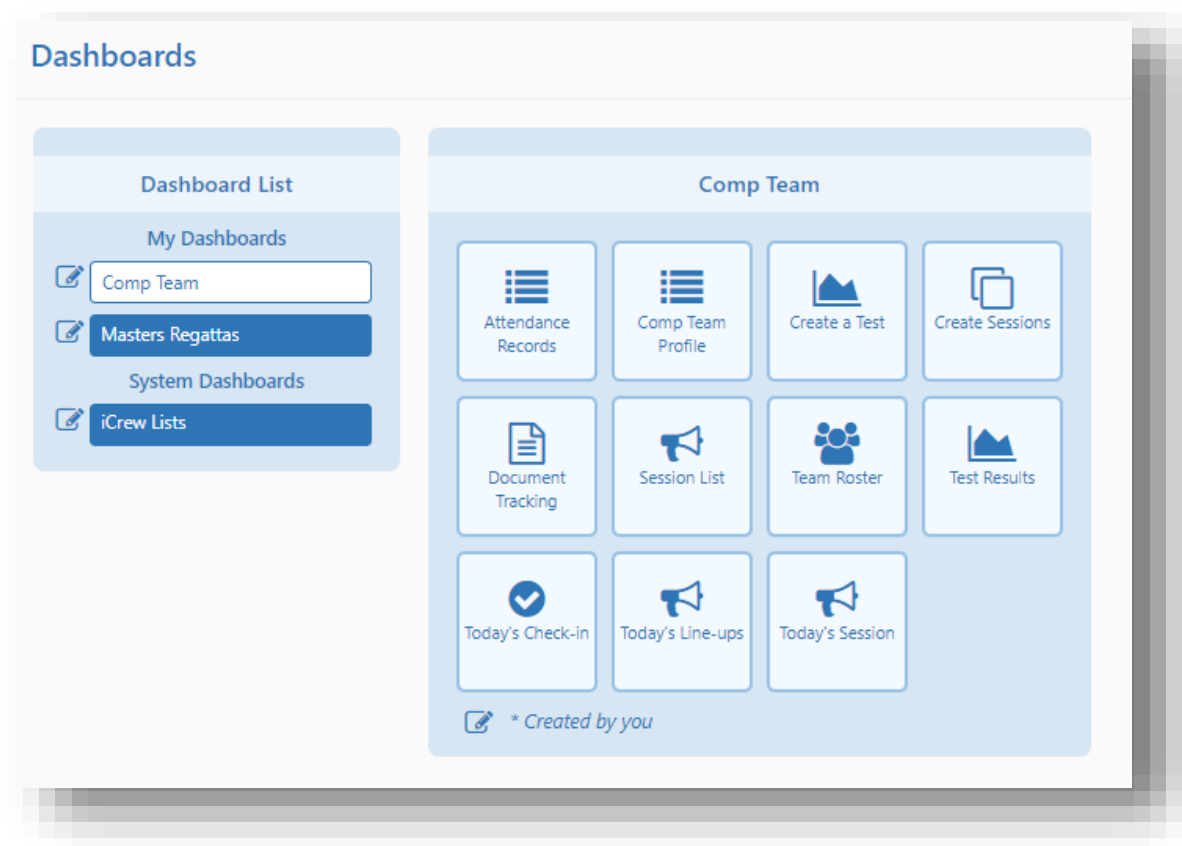

## Boat and seat assignment now shown on rower's tile on check-in page

The check-in page for a practice will now show a rower's boat and seat assignment on their tile. The line-ups must be marked as "public" for this information to be shown.

Instructions: Tap your tile to indicate that you're here or type in your name and tap the checkbox button. Your tile should look like this:

Check-in member: ☐ CHRIS B ☐

[View all line-ups...](#)

A B C	D E F G	H I J	K L	M N	O P Q R	S thru Z
<input checked="" type="checkbox"/> Ann M ^ ANDR BAY - 6	<input checked="" type="checkbox"/> David L SURPRISE - 3	Harley M CHICKA - 1	<input checked="" type="checkbox"/> Karl B Goyena - 3	Marcus A MT. BAKER - 3	<input checked="" type="checkbox"/> Olga J MT. BAKER - 6	Sample A
Arthurs A MT. BAKER - 3	David La CHICKA - 3	<input checked="" type="checkbox"/> Isaac F ANDR BAY - 1	Katelyn S NEVIN - 2	<input checked="" type="checkbox"/> Maritza J ANDR BAY - 7	<input checked="" type="checkbox"/> Roman H MT. BAKER - 1	<input checked="" type="checkbox"/> Sample Adm
<input checked="" type="checkbox"/> Betsy L	<input checked="" type="checkbox"/> Donette K BEAST - 2	Jacquelin M CHICKA - 2	Keven B ANDR BAY - 4	Mark B MT. BAKER - cox	<input checked="" type="checkbox"/> Rusty M GFORCE - 2	Sample R
Calvin I BEAST - cox	Enda K	<input checked="" type="checkbox"/> Jewel D NEVIN - 1	Keven Ba (C) LOPEZ - 2	<input checked="" type="checkbox"/> Marvin C MT. BAKER - 4	<b>O P Q R</b>	<input checked="" type="checkbox"/> Scott C NEVIN - cox
Casey C SURPRISE - 4	<input checked="" type="checkbox"/> Eun M SURPRISE - cox	Jim B ANDR BAY - 2	Lamonte D BEAST - 4	Maryanna C NEVIN - 3		<input checked="" type="checkbox"/> Tamica A ^ NEVIN - 4

## Test results now include Watts

When viewing team test results, you'll now see a column for watts. For [formula](#) for watts comes from Concept2.

Test Results

ALL Masters

NOTE: This result represents an athlete's personal record at that distance.

 Tap to download this data

Show  entries Search:

Length	Set#	Athlete	Gender	Weight Adj	Raw Result	PR	500m Pace	Watts	Age Adj	Wt & Age Adj	Splits
1000m	1			2:55.3	3:10.7	PR	1:35.3	404.38	3:04.5	2:49.1	
1000m	1			2:55.4	3:10.8		1:35.4	403.11	3:05.3	2:49.9	
1000m	1			2:50.0	3:11.3	PR	1:35.7	399.33	3:09.9	2:57.6	
1000m	1			2:59.3	3:11.8		1:35.8	398.08	3:10.2	2:57.9	
1000m	1			2:57.0	3:12.5		1:36.3	391.91	3:06.3	2:50.8	
1000m	1			2:57.6	3:13.2		1:36.6	388.27	3:07.7	2:52.1	
1000m	1			3:07.0	3:13.5	PR	1:36.8	385.87	3:12.5	3:02.0	

## New members default shell permissions and proficiency rating

If you club allows independent rowing, new members will now be set with an "intermediate" proficiency rating and permissions to reserve single, double/pair, and quads/fours shells. Previously, new rowers came in as "unrated" which prevented them from making a reservation until a coach/admin set their proficiency rating. If you would like to change the defaults for your club, contact iCrew.

## Added an option to make rower's weight optional on their profile

If you do not want to require a rower to enter their weight on their profile, contact iCrew to make this change for your club.

**NOTE:** Weight is used in calculating average weight of rowers in a boat line-up and in weight-adjusted erg test results.

## Show rowers that have not been boated for a regatta

When working on line-ups for a regatta, if you refresh the **RACE COUNT INFO**, rower's that have not been placed in a line-up will be highlighted.

The screenshot displays the iCrew interface for managing rowers and regatta information. At the top, the 'ROWERS' section is visible, with a 'Hide absent members' checkbox checked. Below this, a 'Sort order' dropdown is set to 'Side, name'. A list of rowers is shown, including Karl B, Kaven B, Tamica A, Maryanna C, Anderson C, Ann R, Annie D, Barack O, Betsy L, David L, Katelyn S, Lori S, Maggie P, Manda W, Maritza J, and Marvin Ch. Red arrows point to Karl B, Manda W, and Isaac F. Below the rowers list, there are four panels: 'MEMBERS EXPECTED: 25 (3 women, 4 men) LAST COXED INFO', 'MEMBERS CHECKED-IN: 0 SESSIONS ROWED PAST 60 DAYS', 'MEMBERS AWAY' (listing Arthur A, Bill S, Calvin I, Casey C, Catharine G, Charlie A, Christeen P, Conception O, Cornelius M, David La, and a note '\* Away, Absent'), and 'RACE COUNT INFO' (listing Dennis V (1), Harley M (1), Isaac F (0), Jacquelin M (1), Jamie K (1), Karl B (0), Katelyn S (1), Kaven B (1), Lori S (1), and a note '\* Absent (1)'). Red arrows point from the 'MEMBERS AWAY' list to the 'RACE COUNT INFO' list. At the bottom, there are buttons for 'Refresh last coxed info', 'Refresh sessions rowed info', and 'Refresh' under the 'RACE COUNT INFO' panel.

## Tiles displayed for rowers attending a regatta on the regatta information page

At the bottom of the regatta information page, tiles for all attending rowers are now shown. A tile can be tapped to view rower information.

## Enable sending of a message to all attendees of a regatta

A coach or admin can now easily send a message to all rowers attending a specific regatta. Look for this **Message All Attendees** frame at the top of the regatta information page.

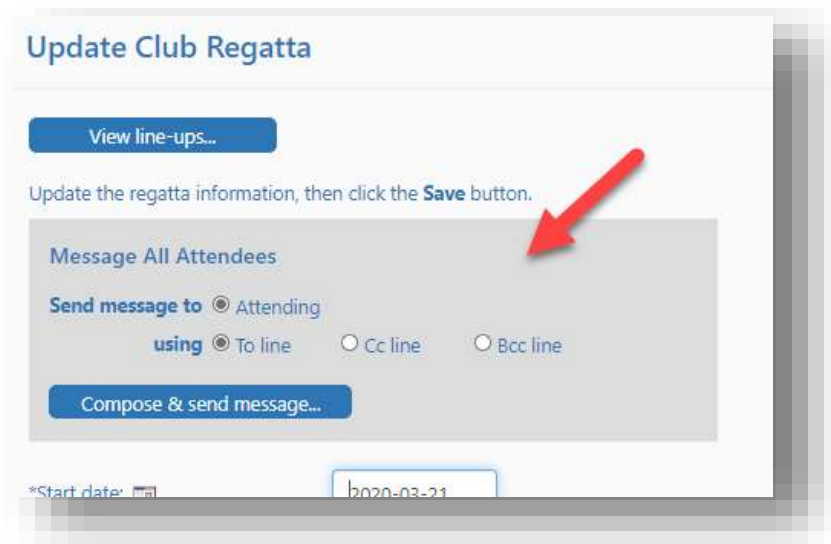

## New page for parents to see their child's attendance plans

If parents have accounts in iCrew and are associated to their children's accounts, a parent can now view their child's attendance plans from their own home page. As a parent, they go to their **My Attendance Plans** tab, then tap the new **My family's attendance plans...** button.

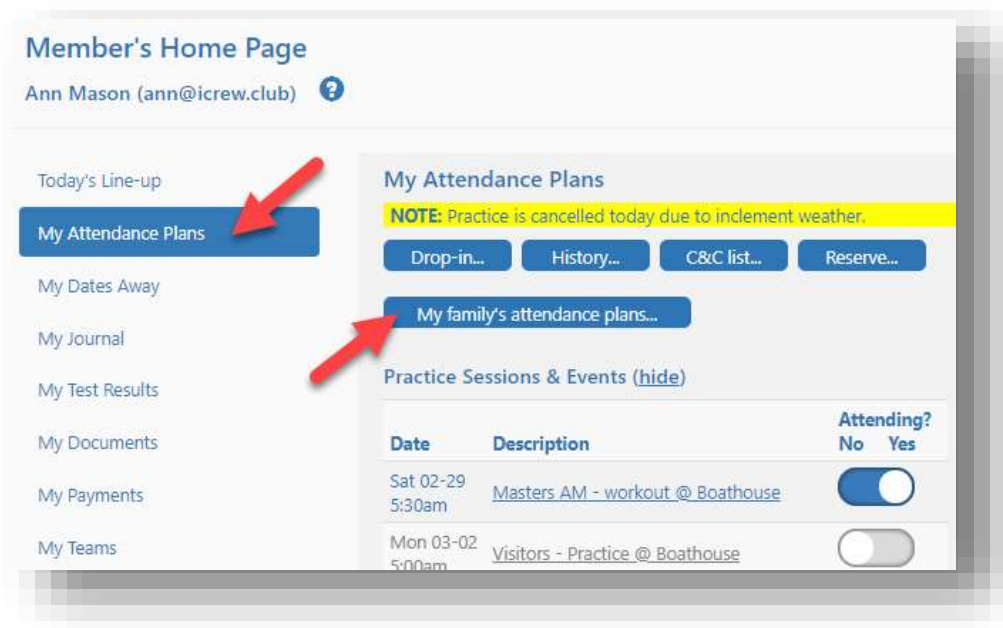

## Reservation calendar shows boats away at a regatta based on trailer load/unload date/time

When boats will be away at a regatta, the reservation calendar now shows tiles for boats based on the trailer load and unload dates/times.

## Paid items now shown on member's My Payments tab on their home page

Items previously paid are now shown on the member's **My Payments** tab along with the amount they paid.

My Payments

**NOTE:** Practice is cancelled today due to inclement weather.

[View my family's payments...](#)

Fee Item	Amount Due	Paid	Due Date	Note to bookkeeper	Edit note	Related Item
<b>Test Two Cart Buttons</b> This is cart button 2 for \$200	\$0.00	<span>Pay...</span> <span>Paid</span>	12-31-2020			
<b>Annual Membership</b> Member annual membership fee	\$600.00	<span>Paid</span>	01-01-2020			
<b>PAID ITEMS</b>						
Fee Item	Amount Paid	Paid	Due Date	Note to bookkeeper	Edit note	Related Item
<b>Test Cart Button1</b> This is cart button 1 for \$100	\$100.00	<span>Yes</span>				
<b>Test Cart Button2</b> This is cart button 2 for \$200	\$200.00	<span>Yes</span>				
<b>Test \$1 Item</b> This is a test item for \$1.	\$1.00	<span>Yes</span>				
<b>Visiting Rowing Fee</b> Fee for visiting rowers	\$1.00	<span>Yes</span>				

## Added optional 4th row of line-ups to a session

For session, you can now add a fourth row of line-ups.

**NOTE:** You must first add a third row after which you can add a fourth row.

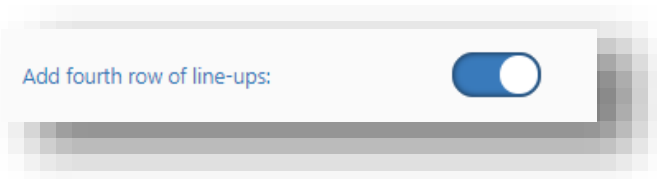

## Added extract option on the session list page

The session list page now includes an option to extract and download the data

Session List

CompMasters

[New sessions...](#) [Session calendar...](#)

☐ Show regattas only

Tap to download this data

Show 50 entries Search:

Update	Date	Day	Time	Team	Title	Location
	2020-03-03	Tue	5:30am	CompMasters	Practice	Boathouse
	2020-03-04	Wed	5:30am	CompMasters	Practice	Boathouse
	2020-03-05	Thu	5:30am	CompMasters	Practice	Boathouse

## Added support to limit access to a discussion channel to a single team

A discussion channel can now be limited to a single team.

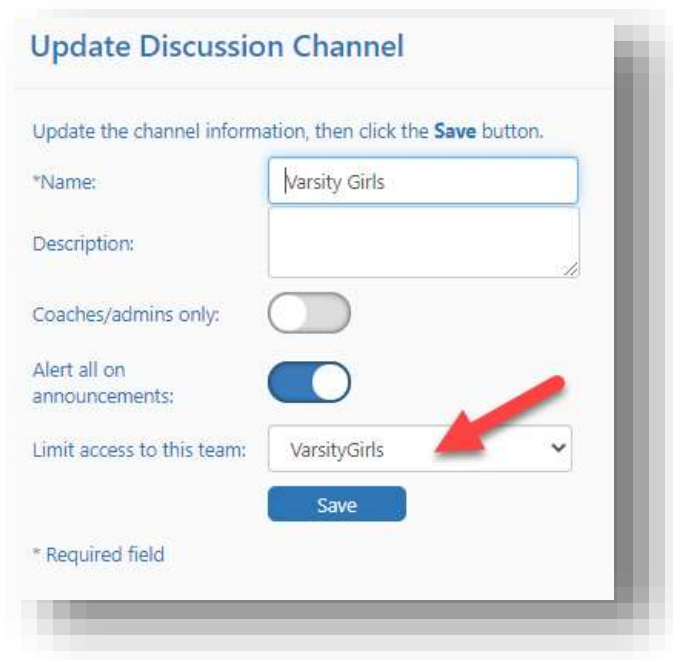

**Update Discussion Channel**

Update the channel information, then click the **Save** button.

\*Name:

Description:

Coaches/admins only: ☐

Alert all on announcements: ☒

Limit access to this team:  

**Save**

\* Required field

## Added support for tile colors for boats and oars

On a boat or oars profile, you can now optionally specify a color for the item's tile as it appears on the line-ups page. The colors can represent anything you decide as a club.



Tile color: ☒ ☐ ☐ ☐ ☐ ☐

If you have any questions about these new features, send the iCrew team an [email](#).

Thanks,

Kevin  
iCrew Team